

# THE MID-AMERICA MEDICAL ASSOCIATION

Sponsored by  
the Office of the Provost,  
the Division of Continuing Education,  
and  
the French and Italian Department  
of the University of Kansas.

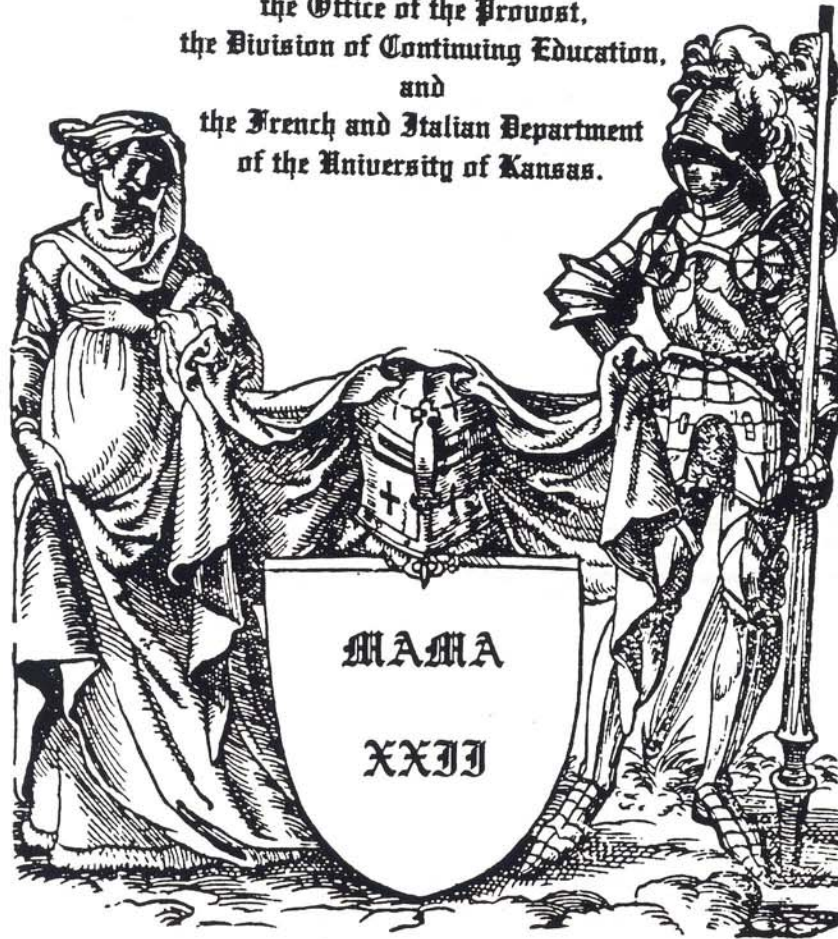

ANNUAL CONFERENCE  
21st FEBRUARY 1998  
KANSAS UNION  
UNIVERSITY OF KANSAS  
LAWRENCE.

# Kansas Union - Floorplan

1321 Oread (13th Street at Jayhawk Boulevard)

Level 6

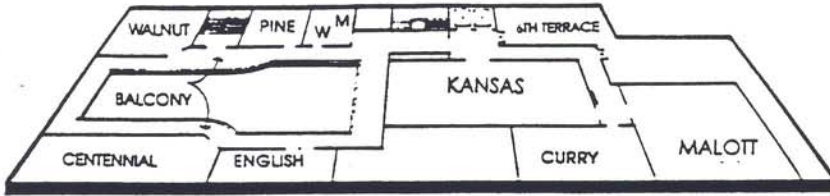

Level 5

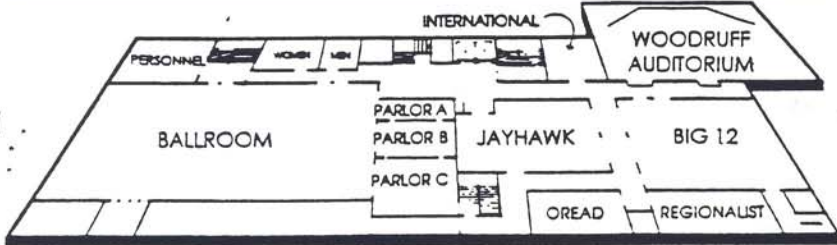

Level 4

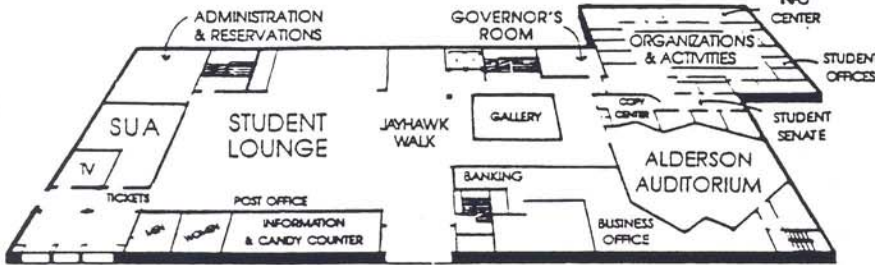

Level 3  
LUNCH

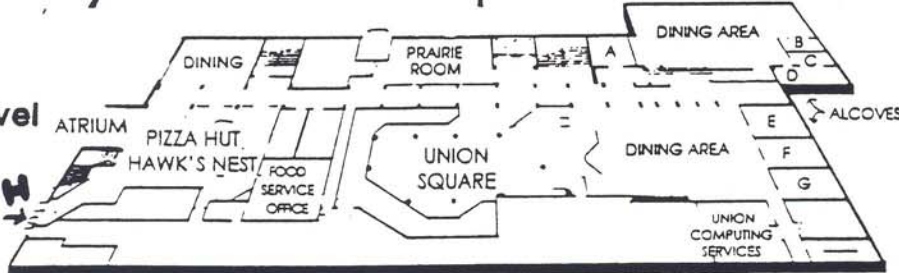

Level 2

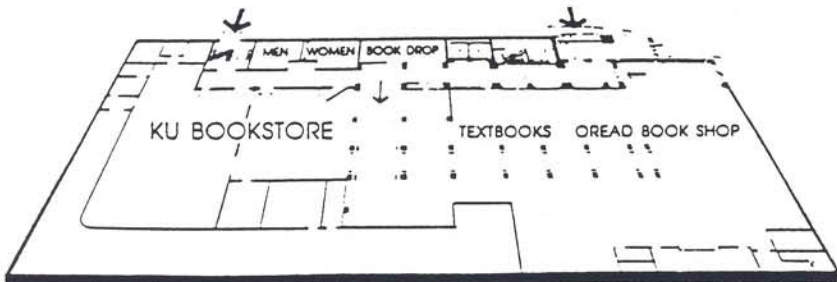

Level 1

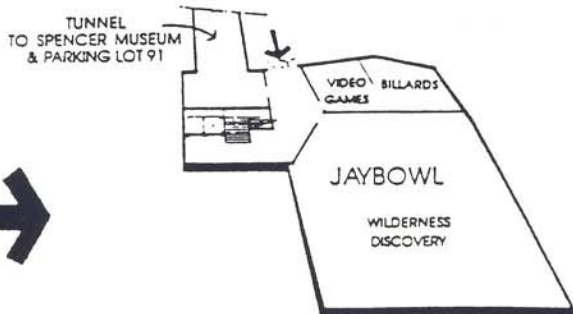

NORTH

## Level



- 4 Administration/Reservation
- 3 Alcoves (A-G)
- 4 Alderson Auditorium
- 3 Atrium
- 4 Banking
- 5 Ballroom
- 5 Big 12
- 1 Billiards
- 2 Bookstore
- 4 Business Office
- 3 Dining Areas
- 6 Centennial Room
- 4 Copy Center
- 6 Curry Room
- 6 English Room
- 3 Food Services
- 4 Governor's Room
- 3 Hawk's Nest
- 4 Information/Candy Counter
- 4 Information Center, KU (OAC)
- 5 International Room
- 1 Jaybowl
- 5 Jayhawk Room
- 4 Jayhawk Walk
- 6 Kansas Room
- 2 KU Bookstore
- 4 Lounge
- 6 Malott Room
- 2 Oread Book Shop
- 5 Oread Room
- 4 Organizations & Activities(OAC)
- 5 Parlors (A, B, C)
- 5 Personnel Office
- 4 Phones (by Alderson Auditorium)
- 6 Pine Room
- 5 Regionalist Room
- 6 6th Terrace (outdoors)
- 4 Student Office/Workstations
- 4 Student Union Activities
- 4 Student Senate
- 2 Textbooks
- 4 TV Room
- 1 Tunnel Entrance
- 3 Union Computing Services
- 3 Union Square
- 1 Video Games
- 6 Walnut Room
- 4 Wheat Room (In OAC)
- 1 Wilderness Discovery
- 5 Woodruff Auditorium



Photo: Bill Towns  
©1994 University of Kansas Memorial Corp

**MAMA XXII: Mid-America Medieval Association**  
21st February 1998  
University of Kansas Union Building, Lawrence.

**8.00-8.45 Registration** (\$10 in advance), Coffee & doughnuts,  
Alderson Auditorium Lobby.

**8.45-9.00 Welcome & Announcements**, Assistant Provost Richard  
S.Givens, University of Kansas and Caroline Jewers, Alderson  
Auditorium.

**9.00-10.30 First Morning Sessions**

**I: REVISITING THE CANTERBURY TALES** (Alderson Auditorium).

Chair: Linda Voigts, UMKC.

Tom Shippey, St.Louis University: "What is the Opposite of  
Phallic Agression?, or, Could Chaucer read Flemish?"

Beverly Boyd, University of Kansas: "Did Chaucer circulate the  
Frame of the Canterbury Tales?"

Robert Howard, Southern Illinois University: "Chaucer's Book  
of the Duchess and the Orpheus Myth."

**II: PRIMARY SOURCES AND MONOGRAPHS ON RELIGIOUS FOLKTALES,  
WITCHCRAFT, AND THE MILITARY IN MEDIEVAL CENTRAL AND EASTERN  
EUROPE.** (Pine Room, Level 6)

Chair: Zoltan.J.Kosztolnyik, Texas A&M University.

Peter Kirk Bacon, Texas A&M : " A Critical Appraisal of the  
Writings of Five Byzantine Military Strategists."

Lori Ann Bell, Texas A&M : "The Scandinavian Connection: How  
the Slavic Pantheon supports the Theory of Rus' Scandinavian  
Origins."

Jennifer D.Thibodeaux, Texas A&M : "Books of Law and the Witch  
in Central and Eastern Europe in the Middle Ages."

**III: BOUNDARIES IN EUROPEAN LEGAL HISTORY** (Walnut Room, Level 6)

Chair: Jim Falls, UMKC.

Arlene M.W.Sindelar, The University of Central Arkansas: " Put  
in her Place: Women and Attorneys in the King's Court of  
England."

Mark R.Munzinger, University of Kansas: "Reflections on the  
Early History of the Supreme Court of German Law at the Royal  
Fortress of Cracow."

Jasonne Grabher O'Brien, University of Kansas: "The ius  
commune Law of War: Giovanni da Legnano's Tractatus de bello."

**10.30-10.45 Coffee Break**, Alderson Auditorium Lobby.

\* The University of Kansas Bookstore, located on level 2 of the Union, has a selection of books of interest to medievalists. They have a display for us, you should find a discount coupon for the Bookstore available at the registration table.

**10.45-12.15 Second Morning Sessions**

**IV: STUDIES IN MEDIEVAL SPANISH AND SOCIAL HISTORY IN HONOR OF LYNN NELSON.** (Alderson Auditorium)

Chair: John Maple, Oklahoma Christian University.

Chuck Bowlus, University of Arkansas at Little Rock: "Warfare and Social Change in Early Medieval Europe."

Clay Stalls, Los Angeles: "The Introduction of Southern French Bishops into Léon-Castile in the late Eleventh and early Twelfth Centuries."

Don Kagay, Albany State College, Georgia: "Defense of the Realm in Medieval Catalan Law."

**V: LANGUAGE, MISREADING, AND DISSENT IN MEDIEVAL LITERATURE** (Pine Room, Level 6)

Chair: David Dinneen, University of Kansas.

Teresa Bargetto-Andrés, Iowa State University: "Lexical Findings from the Fifteenth-Century Spanish Translation of Dante's Divine Comedy."

Elaine Burklow, Southern Illinois University at Carbondale: "Alterations in the A, B, and C-Texts of The Vision of Piers Plowman: The Voice of Critical Dissent."

Eric Matheis, Columbia University, New York: "Questioning the Quest: Gloss of Speech and Act in La Queste del Saint Graal."

**VI: LANGUAGE, SUBVERSION, AND THE PLEASURE OF THE TEXT** (Walnut Room, Level 6).

Chair: Mel Storm, Emporia State University.

Anthony J. Cardenas, The University of New Mexico: "The Pleasure of Medieval Texts, Then and Now: The Fable of the Ass and the Lapdog."

Elisa Narin van Court, Colby College, Maine: "Erotic-Maternal Embrace/Political Union: The Gendered Construction of Exemplary Rule in Havelok and William of Palerne."

Adam Potthast and Patricia S. Burton, Truman State University: "Which Way is the City? Ostensive Language in Augustine."

**12.15-1.15 Lunch** (Level Three Cafeteria, Kansas Union)

\*\*Computer Lab Demonstration by Professor Lisa Bitel and Marie Kelleher (University of Kansas), "WE NEED A FEW GOOD NUNS: Website Demonstration of 'Matrix: Resources for the Study of Religious Women, 500-1500.'" The demonstration will be held in a lab in Budig Hall (formerly Hoch Auditorium) - those wishing to attend the demonstration should gather next to the registration table, where Marie Kelleher will be waiting to guide you there.

\*\*\* Alcoves B & C have been reserved at the the Kansas Union (Level 3, off the main room of the cafeteria, for graduate students and/or those who advise graduate students to meet, eat lunch, discuss professional issues, and exchange information.

\*\*\*\* The Spencer Art Museum (which has a fine medieval collection), as well as the Natural History and Anthropology Museums will be open for you to visit.

\*\*\*\*\* Also located in Lawrence is the J.Hood Bookstore, at 1401 Massachusetts St. (841-4644). They regularly have a stand at the Kalamazoo book exhibit, and have a sizeable number of books on medieval history and culture, including rare and out-of-print works.

#### 1.15-2.30 GENERAL SESSION, Alderson Auditorium.

Introductions, Caroline Jewers & Jim Falls, UMKC.

**PLENARY ADDRESS:** Michel André Bossy, Professor of Comparative Literature, Brown University, Providence, RI: "Marauding for Books during the Hundred Years War."

Prior to a **brief business meeting**, Jim Falls will say a few words in honor of retiring MAMA members Lynn Nelson and Skip Kay.

#### 2.30-2.45 Coffee Break, Alderson Auditorium Lobby.

#### 2.45-4.15 Afternoon Sessions.

#### VII: STUDIES IN DANTE AND CANON LAW IN ORDER OF RICHARD KAY. (Alderson Auditorium).

Chair: Dr. Clay Stalls, Los Angeles.

John Lomax, Ohio Northern University: "Legal Norms and Social Values in Medieval Europe."

Bruce Brasington, West Texas A&M University: "Propter hereticos: Glossators' Agenda in a Cambridge Manuscript of Ivo of Chartres' Panormia."

Marina de Fazio, University of Kansas: "The Narrator in Dante's Commedia."

VIII: SOMETIMES IT'S HARD TO BE A WOMAN - IN MEDIEVAL FRENCH LITERATURE (Walnut Room, Level 6).

Chair: Caroline Jewers, University of Kansas.

Kathy Krause, UMKC: "To Save Men's Souls: Gendered Patterns of Sin and Salvation in Gautier de Coinci's Miracles de Nostre Dame."

Regina F. Psaki, University of Oregon: "Migratory Misogyny: the Chastiemusart and the Veneto Proverbia."

Bob Clark, Kansas State University: "The Lady is a Tramp: The Clerical Misogyny and Social Criticism of Etienne de Fougères"

IX: INTELLECTUAL PROPERTY: ART, COMMERCE, AND MEDIEVAL LAW (Pine Room, Level 6).

Chair: John McCulloh, Kansas State University.

Andrew Larsen, University of Wisconsin-Madison: "The Oxford 'School of Heretics': The Unexamined Case of Friar John."

Patricia Radford, Oklahoma State University: "The Irish Brooch as a Symbol of Status and Rank."

Jason Hardgrave, University of Kansas: "Contracts of Commerce: Legal Instruments of Medieval Trade in the Mediterranean."

Birgit Noodt, University of Hamburg: "Family and Individual: Citizens of Lübeck in the Mirror of their Last Wills in the 14th Century."

For those staying in Lawrence, or dining in Lawrence, a list of local restaurants will be available for consultation.

\*\*\*\*\*

REGISTRATION:

If you plan to attend the Annual Conference, please fill out the form, enclose your **registration fee** if possible (\$10, cheques should be made payable to MAMA), and mail to: **Dr. Caroline Jewers, Dept. of French and Italian, 2056 Wescoe Hall, University of Kansas, Lawrence KS 66045-2120.**



If you arrive early in Lawrence, or if you live locally and wish to meet friends and guests, please feel welcome to a **reception on Friday night**, February 20th, at the home of **Caroline Jewers, 1528 New Hampshire St. Lawrence, KS 66045-2120, tel. 785-865-5632, cjewers@falcon.cc.ukans.edu. Reception begins at 8.00pm.**

**Hotels and Motels:** Attached is a list of local hotels and motels and their rates. A block of rooms at a flat rate of \$72 has been reserved at the Holiday Inn until February 7th for MAMA. Those travelling in groups may be interested to know that the rate is per

room, and that up to 4 people can share. The Eldridge Hotel has reserved 5 Queen suites at \$100, which could be shared. The Eldridge is a lovely old hotel situated in the heart of downtown Lawrence - ideal for restaurants and a late movie. Close to campus and downtown is the charming and affordable Halcyon House Bed and Breakfast - highly recommended. Mention MAMA if you call them ( there may be room shares available there too).

\*\* Try to book accommodations as soon as possible - the Jayhawks have a home basketball game that weekend, which always means more traffic and visitors than usual.

### **Taxi & Shuttle**

If you are coming to Lawrence from Kansas City International Airport, you can reserve a space on the **A-1 Lawrence Airport Shuttle** (785-842-2432). This is a regular service, for which a reservation is needed. You will find the schedule below. The normal cost of the shuttle is \$21 one-way, \$42 round-trip. Mentioning MAMA at time of booking should save a dollar each way. Round-trip tickets must be booked and paid for in advance, and tickets are non-refundable if you cancel less than 12 hours before your scheduled reservation.

The **local Lawrence Taxi Service** can be reached at: 842-8294 (842-TAXI) - this would be a good way to get to the Union if you are staying off-campus.

\* - **Refund/Cancellation Policy:** The University of Kansas Division of Continuing Education reserves the right to cancel the event and return all fees in the event of insufficient registration. The liability of the University of Kansas is limited to the registration fee. The University of Kansas will not be responsible for any losses incurred by the registrants, including but not limited to airline cancellation charges or hotel deposits.

\* - **Program Accessibility:** We accommodate persons with disabilities. Please call the organizer, or mark the space indicated on the registration form and a KU representative will contact you to discuss your needs. To ensure accommodation, please register as early as possible, at least two weeks in advance.

\* - **Equal Opportunity Statement:** The University of Kansas is committed to providing programs and activities to all persons, regardless of race, religion, color, sex, disability, national origin, ancestry, sexual orientation, marital or parental status and, to the extent covered by law, age or veteran status.



★ Visitor parking

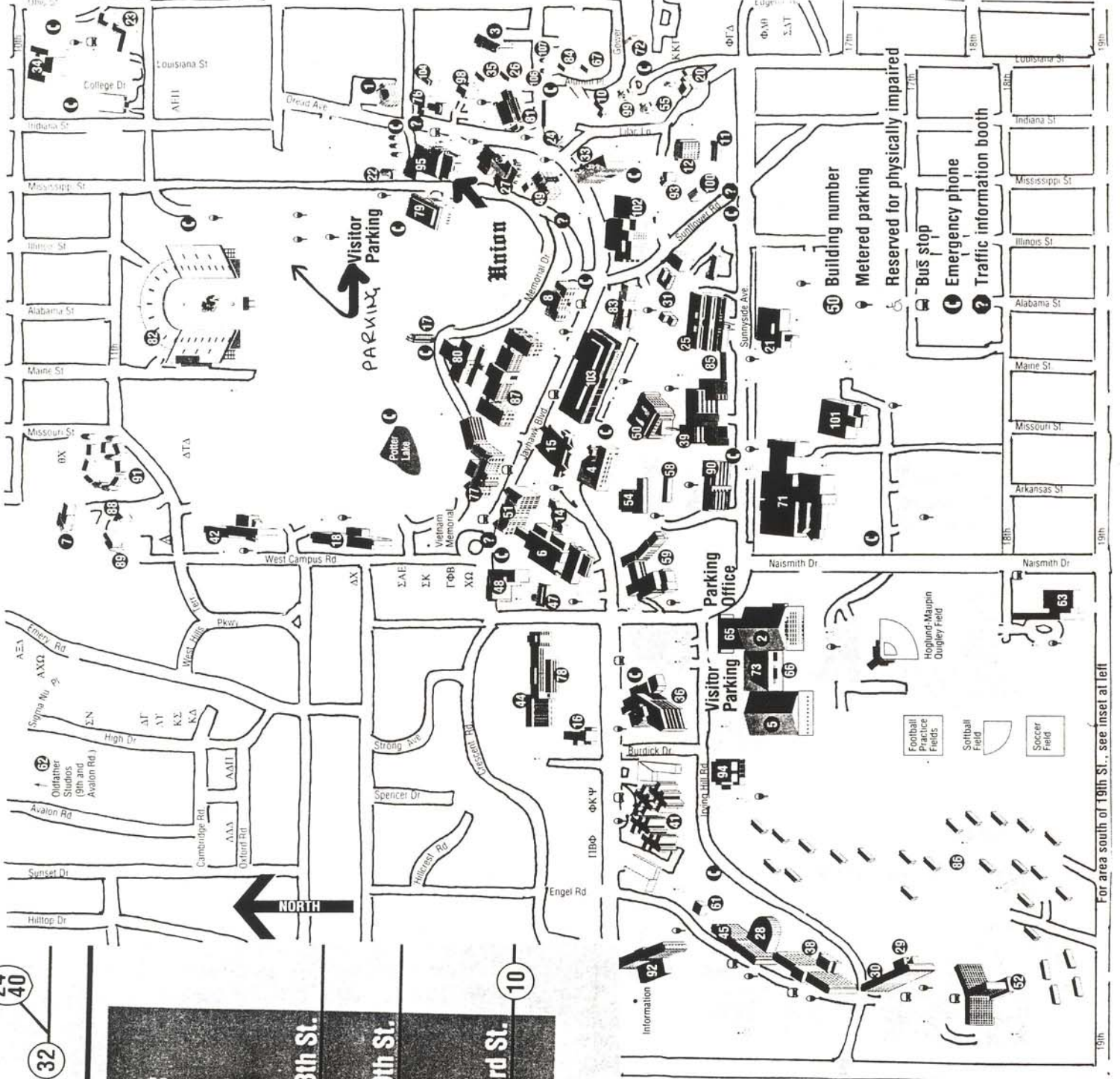
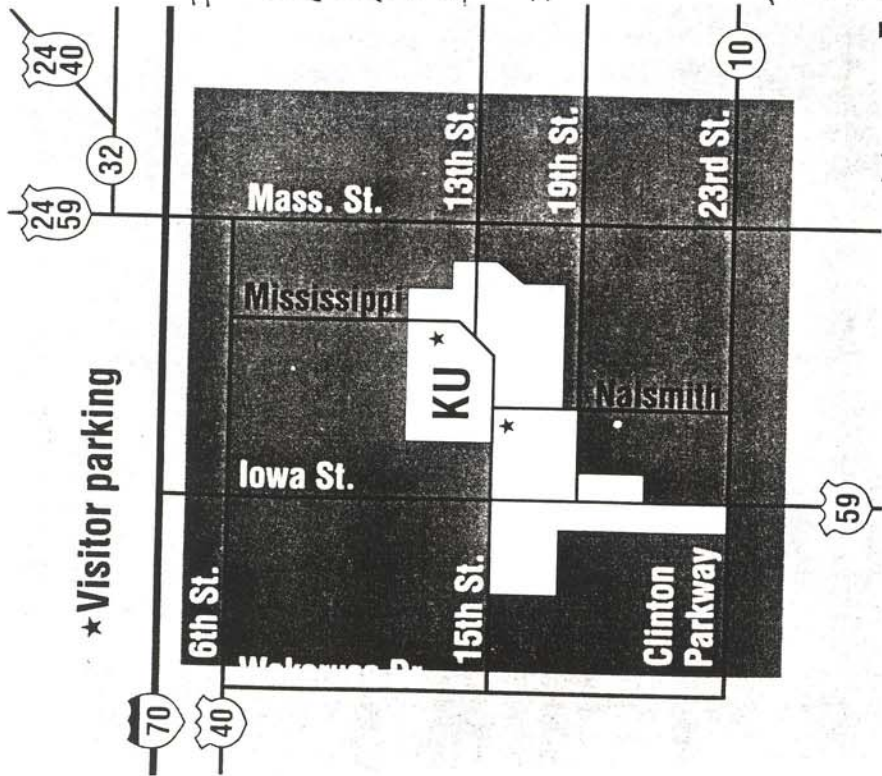

For area south of 19th St., see inset at left

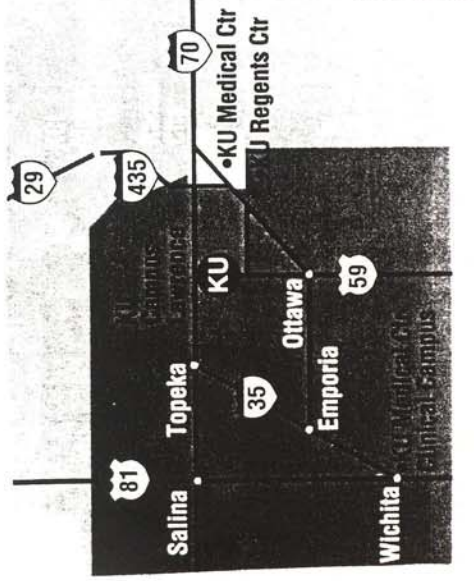



**The University of Kansas**  
**Division of Continuing Education, Academic and Professional Programs**

**LAWRENCE, KANSAS—LODGING INFORMATION**  
*(Room Rates Subject To Change Without Notice)*

<p><b>Best Western Hallmark Inn</b> 730 Iowa 913-841-6500 Nationwide Toll Free 1-800-528-1234</p> <p><b>Rates:</b> (Ask for KU promo)            Single: (queen) 42.95            Double: (full) 50.95            King:            Suite: 80.00            Add Person: 5.00            No. of Rooms: 60</p>	<p><b>Bismarck Inn</b> 1100 N. 3rd Street 913-749-4040 For Reservations Call Toll Free 1-800-665-7466</p> <p>33.90-50.90            39.90-57.90            56.90-63.90            6.00            53</p>	<p><b>Comfort Inn &amp; Suites</b> 740 Iowa 913-838-4242 For Reservations Call Toll Free 1-800-221-2222</p> <p>Under construction. Call toll free number for further information.</p>	<p><b>Days Inn</b> 2309 Iowa 913-843-9100 For Reservations Call Collect or Toll Free 1-800-325-2525</p> <p>Call 913-843-9100 for further information.</p>	<p><b>Eldridge Hotel</b> 701 Massachusetts 913-749-5011 (Suite combinations only/KU rates not valid on special event weekends)</p> <p>76.00            90.00            90.00            235.00            8.00            48</p>
<p><b>Hampton Inn</b> 2300 W. 6th St. 913-841-4994 For Reservations Call Toll Free 1-800-426-7866</p> <p><b>Rates:</b>            Single: 68.00-85.00            Double: 73.00-85.00            King: 73.00-85.00            Suite: 95.00-135.00            Add Person: 5.00            No. of Rooms: 89</p>	<p><b>Holiday Inn/ Holidome</b> 200 McDonald Dr. 913-841-7077 For Reservations Call Toll Free 1-800-HOLIDAY</p> <p>69.00-89.00            69.00-89.00            69.00-89.00            125.00-185.00            No chrg.            192</p>	<p><b>Ramada Inn</b> 2222 W. 6th Street 913-842-7030 For Reservations Call Toll Free 1-800-2-RAMADA</p> <p>54.00-75.00            62.00-75.00            59.00-75.00            108.00-120.00            8.00            110</p>	<p><b>Super 8 Motel</b> 515 McDonald Dr. 913-842-5721 For Reservations Call Toll Free 1-800-800-8000</p> <p>40.88-45.88            50.88-60.88            5.00            48</p>	<p><b>Travelodge</b> 801 Iowa 913-842-5100 For Reservations Call Toll Free 1-800-255-3050</p> <p>36.00            45.00            37.00            50.00            5.00            68</p>
<p><b>Virginia Inn</b> 2907 W. 6th Street 913-843-6611 For Reservations Call Toll Free 1-800-468-8979</p> <p><b>Rates:</b>            Single: 36.95            Double: 42.95            King:            Suite: 54.95            Add Person: 5.00            No. of Rooms: 60</p>	<p><b>Westminster Inn</b> 2525 W. 6th Street 913-841-8410</p> <p>32.00            44.00            4.00            60</p>	<p><b>Bed &amp; Breakfast Christopher's House</b> 643 Tennessee 913-841-9999</p> <p>(Mon.-Thurs.-59.00- includes continental breakfast/Fri.-Sun.- 65.00-includes complete breakfast)</p>	<p><b>Bed &amp; Breakfast The Halcyon House</b> 1000 Ohio 913-841-0314</p> <p>45.00-85.00            (Rate depends on accommodation selected-includes complete breakfast)</p>	

*Please make your own reservations directly with the housing accommodations of your choice.  
 Be sure to tell the reservations clerk which program you are attending.*

# A-1 Airport Shuttle of Lawrence

For Reservations call: (785) 842-2432 or (800) 736-1090 or FAX (785) 842-0674  
**Reservations Taken From 6:00 am to 11:30 pm 7 Days A Week**

Please Schedule 12 Hours In Advance

Be Prepared to Be Picked Up 1 Hour Before Shuttle Departs From Lawrence

**\*CURRENT SCHEDULE - June 1997**

DAYS INN	KANSAS UNION	HAMPTON INN	HOLIDAY INN	ELDRIDGE (Departs)	ARRIVES KCI	DEPARTS KCI	ARRIVE LAWRENCE
	EXPRESS	BY REQUEST	5:00 AM		5:50 AM	6:00 AM	7:00 AM
6:00 AM	B	B	6:30 AM	6:40 AM	7:40 AM	8:20 AM	9:20 AM
7:05 AM	Y	Y	7:35 AM	7:45 AM	8:45 AM	9:20 AM	10:20 AM
8:20 AM			8:50 AM	9:00 AM	10:00 AM	10:40 AM	11:40 AM
9:45 AM	R	R	10:10 AM	10:20 AM	11:20 AM	12:00 NOON	1:00 PM
11:00 AM	E	E	11:30 AM	11:40 AM	12:40 PM	1:20 PM	2:20 PM
12:20 PM	Q	Q	12:50 PM	1:00 PM	2:00 PM	2:40 PM	3:40 PM
1:40 PM	U	U	2:10 PM	2:20 PM	3:20 PM	4:00 PM	5:00 PM
3:00 PM	E	E	3:30 PM	3:40 PM	4:40 PM	5:20 PM	6:20 PM
4:00 PM	S	S	4:30 PM	4:40 PM	5:40 PM	6:20 PM	7:20 PM
5:20 PM	T	T	5:50 PM	6:00 PM	7:00 PM	7:40 PM	8:40 PM
6:30 PM			7:00 PM	7:10 PM	8:10 PM	8:50 PM	9:50 PM
8:30 PM	BY	RESERVATION	ONLY	8:30 PM	9:40 PM	10:20 PM	11:20 PM
9:50 PM	BY	RESERVATION	ONLY	9:50 PM	11:00 PM	11:40 PM	12:40 AM

\* PLEASE NOTE; DUE TO VARIATIONS IN TRAFFIC, WEATHER, AND PASSENGER LOADS SCHEDULE MAY VARY  
 \* 24 HOUR TRANSPORTATION AVAILABLE; OFF "PRINTED SCHEDULE TIMES" CALL FOR RATES

**VISA/MASTERCARD™  
 DISCOVER™  
 AMERICAN EXPRESS™  
 (NO CHECKS)**

For additional \$6.00 We Will Pick You Up At  
 Any Location Within Lawrence City Limits.  
 Home Delivery Free

CALL FOR GROUP  
 DISCOUNTS  
 (5 or more passengers)

\*\*\*\*\*  
Return this form with your registration fee of \$10 to: Dr. Caroline  
Jewers, Dept. of French and Italian, 2056 Wescoe Hall, University  
of Kansas, Lawrence KS 66045-2120.

I PLAN TO ATTEND THE CONFERENCE.

Name & Address:

---

---

I am bringing \_\_\_\_\_ guests.

Amount enclosed: \_\_\_\_\_

**Special Accommodation**



If you will need special accommodation, please mark the  
space below and you will be contacted personally by a  
conference representative.  
Contact telephone number: (       )

---

I plan to attend the reception on Friday night: \_\_\_\_\_ YES, \_\_\_\_\_ NO  
(If you are not sure now, check here \_\_\_\_\_ and feel free to attend  
if you can).

HELP YOUR MAMA!

Please help us to update our records, whether you are attending or  
not, by identifying colleagues, students, and friends who should be  
on our list and receiving information.

Name:

Affiliation:

---

---

Address:

---

---

---

\*(please list any other names on the other side of this  
sheet)