

*Mid America
Medieval
Association*

March 4, 1989



Sponsors

Department of History
Office of Academic Affairs
in cooperation with
Division of Continuing Education
The University of Kansas

MAMA 13

Mid America Medieval Association Thirteenth Annual Meeting

University of Kansas

Lawrence, Kansas

March 4, 1989

Program

- 8:30 Registration and Coffee
Fifth Floor Lobby, Kansas Union
- 9:00 Welcome
Jayhawk Room

New Directions

David H. Miller, University of Oklahoma, presiding
Jayhawk Room

- 9:30 **Karl Morrison**, Rutgers University
The Pathology of Conversion
- 10:00 **Lynn Nelson**, University of Kansas
The Place-names of the Val Ancha and the Fall of Roman Spain



Anglo-Saxon Studies

Linda Voigts, University of Missouri, Kansas City, presiding
Regionalist Room

- 9:30 **Jon Wilcox**, University of Iowa
Funny Kennings: A Key to Anglo-Saxon Humor?
- 10:00 **Mary Vermillion**, University of Iowa
Waves, Wombs, and Wyrð: Images of the Other in Beowulf

Medieval Costume

Richard Clement, University of Kansas, presiding
International Room

- 9:30 **Robin B. Goldman**, Chicago, and **Verna Rutz**, Kansas City
Costume as an Approach to Medieval Studies

Coffee Break

Teaching the Middle Ages

Carolyn Nelson, University of Kansas, presiding
International Room

- 11:00 **Mel Storm**, Emporia State University
Knighthood and Clerikdom: Warriors in the Chaucer Class
- 11:30 **Ronald E. Hess**, Montana State University
The Name of the Rose and Architectural Design



The Venerable Bede

Richard Ring, University of Kansas, presiding
Regionalist Room

- 11:00 Derek Baker, University of North Texas
Bede and the Anglo-Saxon Missions to the Continent: Some Revisionary Thoughts
- 11:30 Sam Swisher, University of North Texas
Bede as a Crisis Historian

Manuscript Studies

Alexandra Mason, University of Kansas, presiding
Oread Room

- 11:00 Bruce C. Brasington, University of California, Los Angeles
The Manuscript Tradition of Ivo of Chartres' Letters
- 11:30 Thomas M. Izbicki, Wichita State University
Northern European Scribes in Renaissance Italy

Luncheon

A Medieval Collation and Entertainment
by the Society for Creative Anachronism

- 12:30 Saint Lawrence Catholic Campus Center
1631 Crescent Road (transportation will be provided)

General Session

Karl Morrison, President of MAMA, presiding
Jayhawk Room

- 2:00 Joseph H. Lynch, Ohio State University
*Untitled Pictures in the Family Album:
Exploring "Fictive" Kinship in Medieval Europe*

Law, Government, and Society

Ronald Steckling, University of Southern Illinois at Edwardsville, presiding
Jayhawk Room

- 3:15 Clay Stalls, University of California, Los Angeles
*The Legal Right of Women to Hold Land
and Its Significance for Settlement in the Ebro River Valley*
- 3:45 Donald J. Kagay, Texas Medieval Association
*The Clash of Royal and Papal Law: The Resolution of Lay Murder
of High Clergy in the Twelfth- and Thirteenth-Century Crown of Aragon*
- 4:15 Glenn E. Sanders, Oklahoma Baptist University
Thirteenth-Century Origins of English Bureaucracy

Medieval Women

Beverly Boyd, University of Kansas, presiding
International Room

- 3:15 Carl Kelso, University of North Texas
Heloise and Her Nuns: Argenteuil and the Paraclete Compared
- 3:45 Benjamin Moore, University of Iowa
Pilgrimage and Narrative Order in The Book of Margery Kempe
- 4:15 Pamela K. Shaffer, Fort Hays State University
Role Types as Illusion in The Tretis of the Tua Mariit Wemen and the Wedo



Medieval Thought

Bruce Bubacz, University of Missouri, Kansas City, presiding

Regionalist Room

- 3:15 **Luis Cortest**, University of Oklahoma
Saint Thomas' Commentary on the Metaphysics in Light of Recent Interpretations
- 3:45 **Edwin J. Westermann**, University of Missouri, Kansas City
Robert Grosseteste and the Virtues of Compassion and Mutual Responsibility
- 4:15 **A. Lisa Merklin Lewis**, Cornell University
Tyrannicide: Heresy or Duty?

Monastic Mentalities

Oliver Phillips, University of Kansas, presiding

Oread Room

- 3:15 **Robyn Lee**, University of North Texas
*A Crisis of Over-explanation:
Some Comments on Peter Brown's View of Iconodolatry in the West*
- 3:45 **Thomas Renna**, Saginaw Valley State University
The Jews According to Gregory the Great and the Late Latin Fathers
- 4:15 **Marshall Crossnoe**, University of Texas at Arlington
The "Cistercian Connection": An Analysis of the Monastic Influence Evident in Otto of Freising's Chronicle of the Two Cities and Deeds of Frederick Barbarossa

Medieval Art

Spencer Museum of Art, Medieval Gallery (3rd floor)

- 3:15 **Marilyn Stokstad and Steven Goddard**, University of Kansas
Medieval Art at Kansas: A Free-for-all Discussion with the Curators



Exhibitions

Spencer Museum of Art

Ancient Corinth: Coins from the Seaver Collection and ceramics from the University of Missouri Museum of Art. The White Gallery (2nd floor).

Zen Painting. The Kress Gallery (4th floor).

Spencer Research Library

The Discovery of Medieval England: An exhibition organized by Richard Clement, of special interest to Anglo-Saxonists. **Open only from 9 a.m. until 1 p.m.**

Books

A selection of recent scholarly books about the Middle Ages has been made available by The Scholar's Choice bookshop for your inspection in the fifth-floor lobby of the Kansas Union.

CONFERENCE INFORMATION

Location:

The Saturday sessions will be in the Kansas Union building at 13th & Oread on the K.U. Campus. The Saturday luncheon will be in the dining room at the Saint Lawrence Catholic Campus Center located at 1631 Crescent Road.

Reception:

On Friday evening March 3, there will be a reception from 8:00-11:00 p.m. in the Jayhawk room at the All Seasons Motel located at 23rd and Iowa.

Registration:

Conference registration will start at 8:00 a.m. Saturday on Level 5 of the Kansas Union building.

Housing:

A block of rooms has been reserved at the All Seasons Motel located at 23rd & Iowa (telephone 913-843-9100). Make your room reservations directly with the motel. The rates are \$28.00 single and \$33.00 double. Be sure to indicate that you are attending the Mid America Medieval Association Conference. Information on other accommodations is available on request.

Kansas City Airport Connections:

Kansas City International Airport is located sixty miles from Lawrence. Limousine service is available. Advance reservations are required. One-way fee, if paid in advance, is \$22.00. If paid on the day of travel, fee is \$25.00 one-way. Call Corporate Coach at 913-841-5466.

Fees:

The registration fee is \$10.00 and the Saturday luncheon is \$7.00. Checks should be made payable to the University of Kansas and sent to Karl Kappelman, Continuing Education Building, the University of Kansas, Lawrence, Kansas 66045-2607. Luncheon reservations must be made by February 17th.

Refunds:

A full refund of fees will be made if requested in writing and received by March 1.

Parking:

Free parking is available on Saturday in Lot 91 located immediately west of the Kansas Union building off Mississippi street.



Conference Officers

Karl Morrison ----- President
James Falls ----- Secretary
Richard Kay ----- Program & Local
Arrangements



LEVEL 5

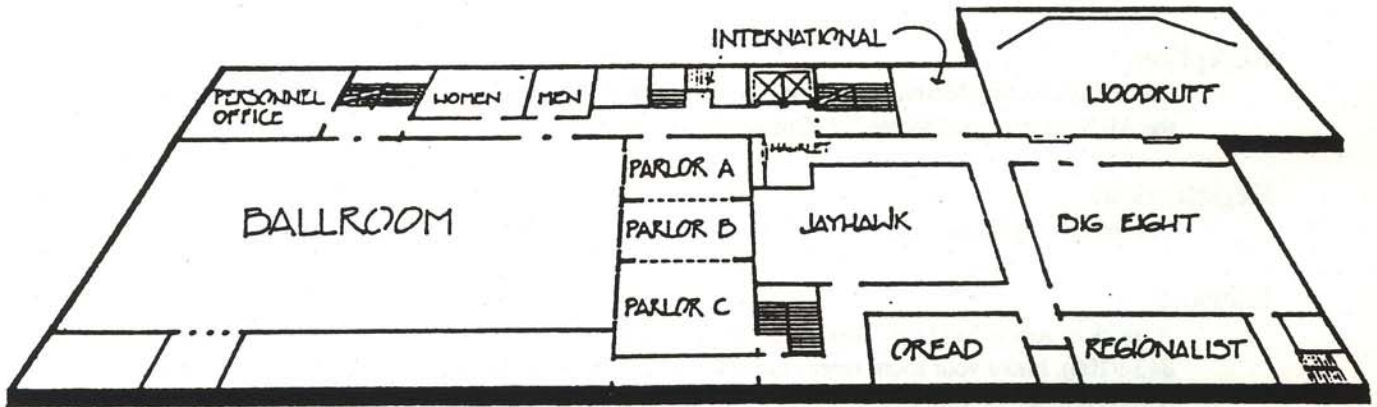



The 1989 Mid America Medieval Association Conference

March 3 - 4, 1989

AA92020

Advance Registration Form

Name _____

Street _____

City _____ State _____ Zip _____

Institution _____

Please check fee and indicate if luncheon is desired. Luncheon reservations must be made by February 17th.

___ Fee \$10.00

___ Saturday luncheon \$7.00

Make checks payable to:
The University of Kansas

Mail to:
Karl Kappelman, Program Manager
Continuing Education Building
The University of Kansas
Lawrence, Kansas 66045-2607
Phone: 913-864-3284

